

---

# ***Indianapolis-Marion County Public Library Construction Highlights - The Learning Curve @ Central Library March 2006***

---

When the old Central Library opened its doors in 1917, the Riley Room for Young People became the center of activity for children and families visiting the Central Library.



**Riley Children's Room 1924**

Over the years, the Library adapted and expanded the collection and award-winning programs to meet the needs of all children and families in pursuit of knowledge and understanding.

In the 21<sup>st</sup> Century, the demand for a highly literate and skilled workforce has created a need for young people to develop interpretive and critical thinking skills at an early age.

---

# *Indianapolis-Marion County Public Library*

## *Construction Highlights -*

### *The Learning Curve @ Central Library*

#### *March 2006*

---

The Learning Curve @ Central Library, a unique flexible space located off of the Atrium level, will extend traditional library services to children and teens by taking advantage of technology and multi-media resources.

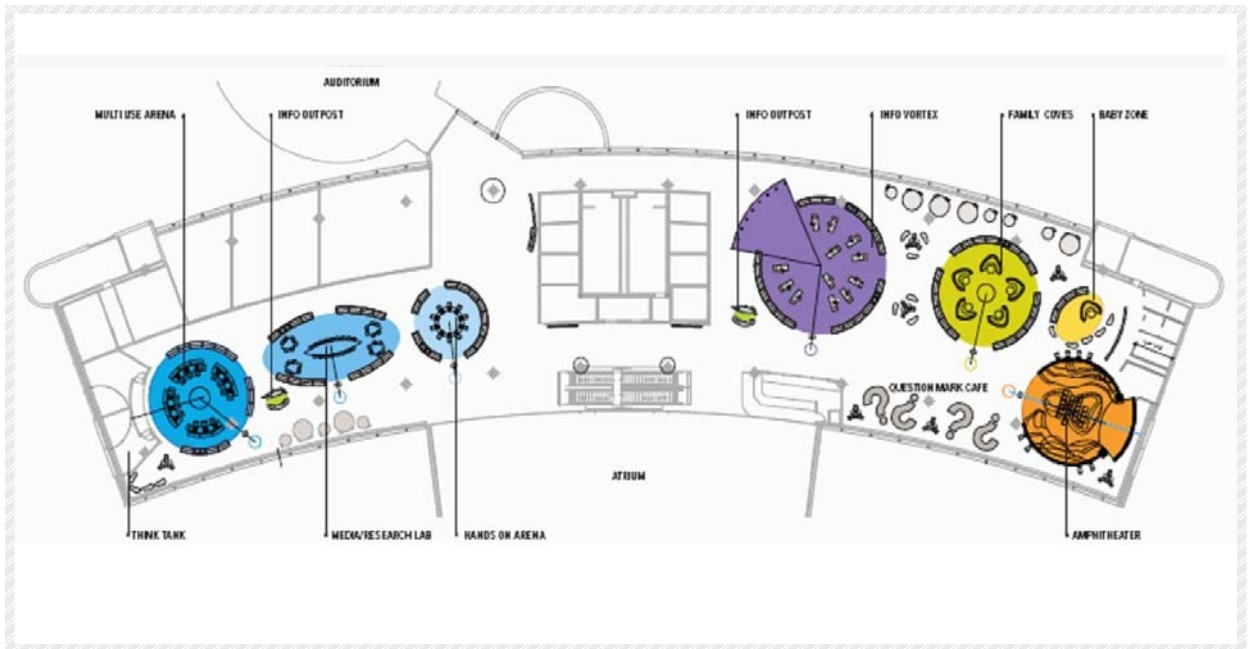

**The Curve floor plan**

With its focus on information literacy, the Library and its design team looked to Ralph Appelbaum Associates ([www.raany.com](http://www.raany.com)), planners and designers of educational environments and exhibitions, to create an informal, high-energy space dedicated to help young people from babies to teens become avid readers ready to meet the challenges of the information ages.



**The Theater**

---

# ***Indianapolis-Marion County Public Library Construction Highlights - The Learning Curve @ Central Library March 2006***

---

Young people visiting the Learning Curve will be inspired and challenged by hands on activities, group programs, and service projects based on current models for teaching information skills that complement Indiana Educational standards.



**The Vortex @ the Curve**

The Information Vortex - the visual signature piece at the Curve – invites visitors into the area with moving images projected onto a vortex shaped structure that represents the continual movement of data from chaos to order.

The Curve will have several spaces for parents and caregivers to enjoy constructive, creative time with their children – in the Baby Zone, in the Theater, in a Group Cove, or exploring shapes and patterns at the Activity Wall.



**Group Cove**

---

# **Indianapolis-Marion County Public Library**

## **Construction Highlights -**

### **The Learning Curve @ Central Library**

#### **March 2006**

---

Young people can work together to access and use information to solve problems and produce their own original projects in the Tech lab, the Arena, and Research Central. Other areas to explore are the Think Tank and the Multi-media Lab.

Activities that inspire curiosity and encourage inquiry - help kids to become better problem solvers and critical thinkers.



**Info Cart**



**Zone Finder @ The Curve**

The Learning Curve @ Central Library is destined to become a favorite place to visit for children and families to the downtown Indianapolis area.